

Touchless & Cashless for Seamless Smart Parking



TIMETEC SMART LPR PARKING

TimeTec Smart LPR can read car plate numbers to the highest accuracy, up to 99.8% for standard car plate number, to achieve a ticketless, cashless, and touchless experience for casual and season parking. TimeTec Smart LPR can be integrated with multiple payment methods, for instance, eWallet Direct for seamless parking, the parking fee is auto deducted from the user's eWallet when exiting the parking site; or scan QR for online payment, or APM Autopay Machine before exit, or Payment (Exit TPK) for TNG card or credit/debit card payment at the exit lane.

- **MACHINE LEARNING**
Embedded with deep learning technology that constantly improves reading accuracy.
- **TOUCHLESS PARKING ACCESS**
Hands-free when entering and exiting parking sites.
- **MULTIPLE PAYMENT METHODS**
Support credit card, debit card, eWallet, FPX, TnG Card, etc.
- **ANALYTIC DASHBOARD**
Real-time, improve management efficiency.
- **MULTIPLE LOCATIONS**
Centralize management and reporting, improve productivity.
- **VALIDATION FEATURE**
Promo code made easy, suitable for shopping malls, hotels, convention halls, etc.
- **CONNECT TO NEXT ACTIVITIES**
Liberate data flow to build a better ecosystem for smart building.
- **TIMETEC EWALLET DIRECT PARTICIPANTS**
Touch n' Go, Setel, more to onboard.
- **AVAILABLE BACKUP PAYMENT METHODS**
Auto Pay Machine, Touch n' Go card and Credit/Debit Card.
- **TIMETEC PARKING ANALYTICS**
Comprehensive and interactive analytics charts to improve management efficiency.
- **NEXT ACTIVITIES**
Visitor management, security, access control, advertisement, liberate data flow to build a better ecosystem for smart building.
- **ONE-STOP PMS**
Consolidate all casual parking, season parking, enforcement and valet parking modules.
- **LPR MODELS**
Multiple LPR models L series, M series and H series and sub-series to choose from.
- **E-INVOICE READY**
e-Invoice compliance and direct links with LHDN MyInvois Portal.



Read More

SYSTEM DIAGRAM 1 : LPR with Multiple Payment Methods

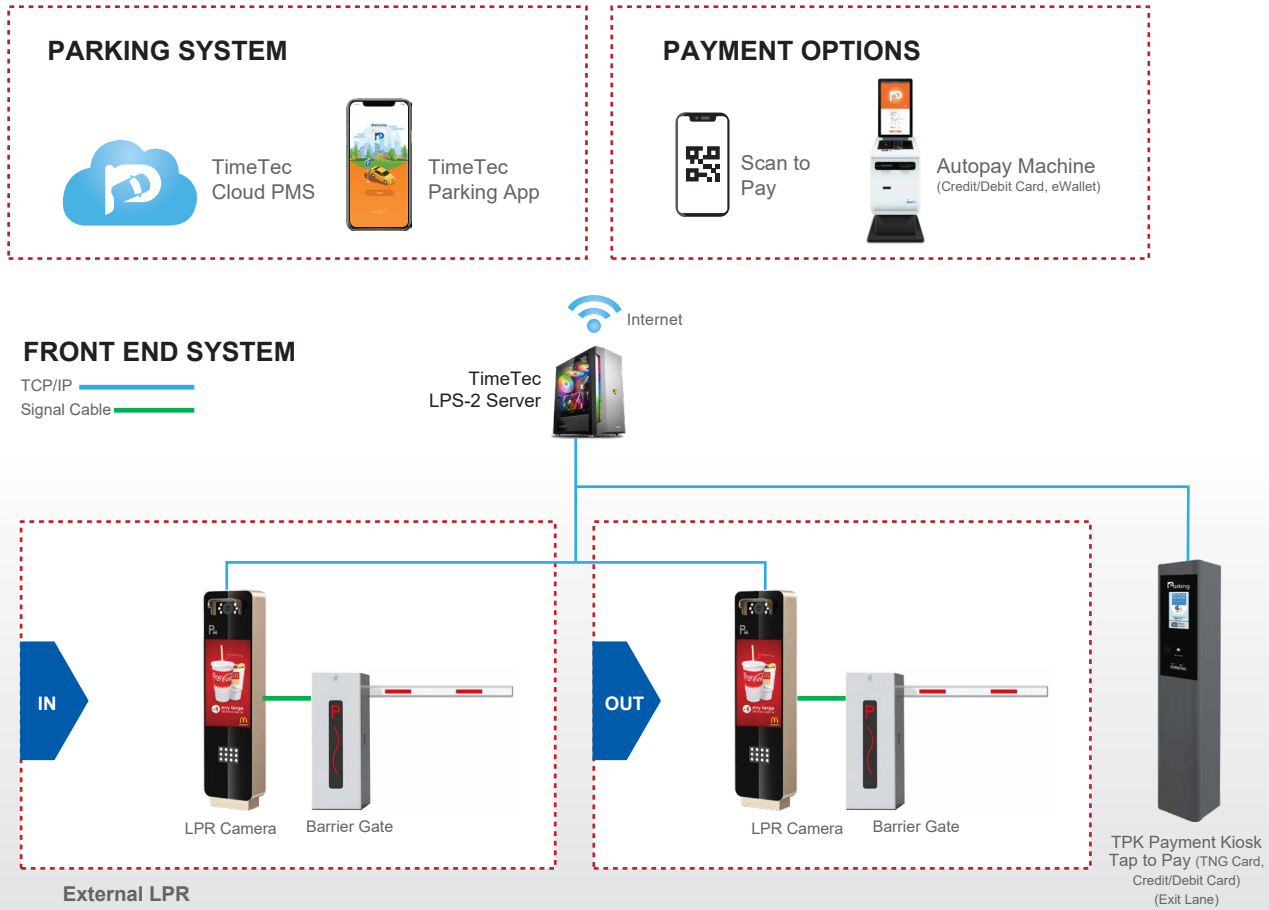

SYSTEM DIAGRAM 2 : eWallet Direct

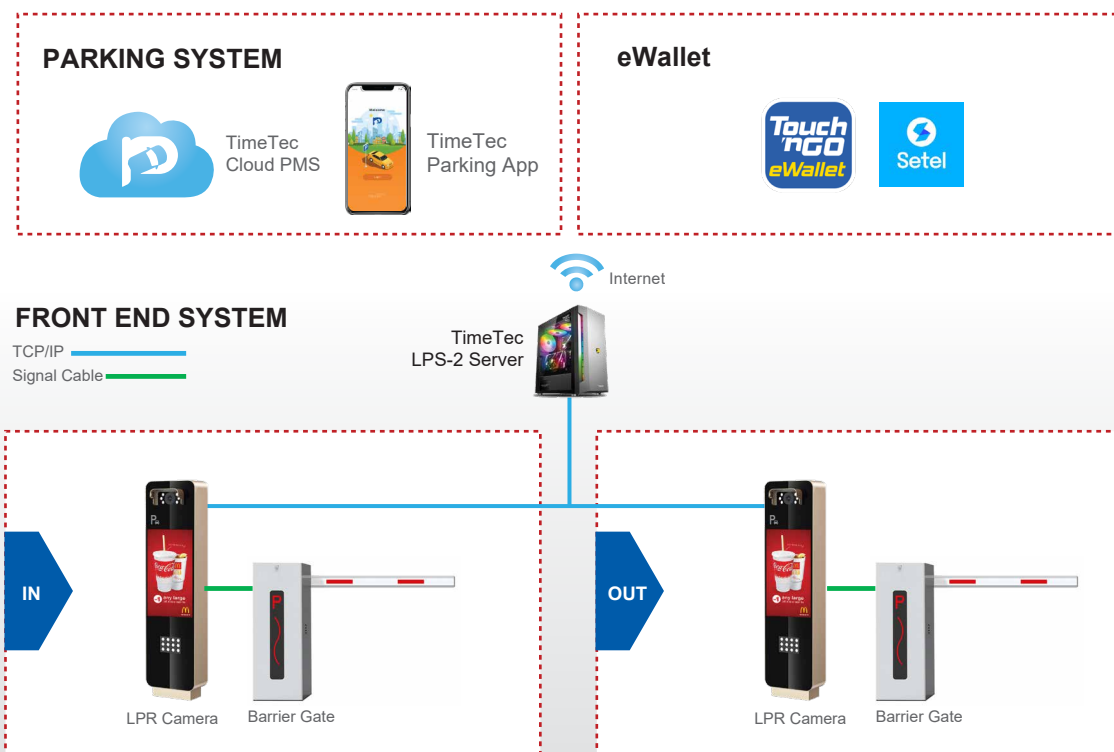

SPECIFICATIONS



MODEL	L Series*		L2 Series*	M Series	H Series
CAMERA	K Model	D Model	V Model	VA Model	VA Model
Camera Housing	Yes	Yes	Yes	No (Embedded module)	No (Embedded module)
Image Sensor	1/3" Progressive Scan CMOS	1/1.8" CMOS	1/2.8" starlight-level CMOS	1/2.8" starlight-level CMOS	1/2.8" starlight-level CMOS
Max Resolution	Jpeg 1920 x 1200	2688 x 1520	1920(H) x 1080(V)	1920(H) x 1080(V)	1920(H) x 1080(V)
Min. illumination	Color: 0.022Lux@ (F1.2, AGC ON), B/W: 0.011Lux@ (F1.2, AGC ON)	10.001 Lux@F1.4 (Color, 30IRE), 0.0002 Lux @F1.4 (B/W, 30IRE) 0Lux (Illuminator on)	Color: 0.01Lux	Color: 0.01Lux	Color: 0.01Lux
Shutter Speed & Lens	1/30 s to 1/100,000 s, 3.1 mm to 6 mm, Support IR Cut Filter	Auto/Manual 1/25s – 1/100,000s	0-1ms or customized (2.8~12mm lens)	0-1ms or customized (2.8~12mm lens)	0-1ms or customized (2.8~12mm lens)
Image Setting	Saturation, Brightness, Contrast, image flip, gain, exposure time	Saturation, Brightness, Contrast, image flip, gain, exposure time	Saturation, Brightness, Contrast, image flip, gain, exposure time	Saturation, Brightness, Contrast, image flip, gain, exposure time	Saturation, Brightness, Contrast, image flip, gain, exposure time
Video Compression	H.264/H.265/MJPEG	H.264H; H.264M by default; H.265; MJPEG; H.264M	H265/H264/MJPEG/ intelligent detection structured data output	H265/H264/MJPEG/ intelligent detection structured data output	H265/H264/MJPEG/ intelligent detection structured data output
Picture Format & Analytic	JPEG with configurable quality, Support LPR	JPEG with configurable quality, Support LPR	JPEG with configurable quality, Support LPR	JPEG with configurable quality, Support LPR	JPEG with configurable quality, Support LPR
LPR Accuracy	99.70%	99.70%	99.80%	99.80%	99.80%
Comprehensive Capturing Recognition Rate	≥99.99%	≥99.99%	≥99.99%	≥99.99%	≥99.99%
Working Temperature & Humidity	-25°C to 70°C, 90% or less (non-condensing)	-30°C to +65°C, 10%~90% (non-condensing)	-25°C to 70°C, 90% or less (non-condensing)	-25°C to 70°C, 90% or less (non-condensing)	-25°C to 70°C, 90% or less (non-condensing)
Network Interface	1 channel 10/100Mbps adaptive RJ45	1 channel 10/100Mbps adaptive RJ45	1 channel 10/100Mbps adaptive RJ45	1 channel 10/100Mbps adaptive RJ45	1 channel 10/100Mbps adaptive RJ45
Communication Interface	1 RS-485 Port. IO output: 2 channels; IO input: 3 Channel		IO output: 2 channel, IO input: 4 channel, RS485: 1 channel	IO output: 2 channel, IO input: 4 channel, RS485: 1 channel	IO output: 2 channel, IO input: 4 channel, RS485: 1 channel
Extra Deep Learning Technics	—	—	2 million starlight imaging effect, dual core processor CNN acceleration	2 million starlight imaging effect, dual core processor CNN acceleration	2 million starlight imaging effect, dual core processor CNN acceleration
LPR Algorithm Supports	Malaysia Car Plate	Malaysia Car Plate	Malaysia, Singapore & Thailand Car Plates	Malaysia, Singapore & Thailand Car Plates	Malaysia, Singapore & Thailand Car Plates
Power Supply	12 VDC, PoE (802.3af) or AC100V~240V	12 VDC, 2 A and POE: 802.3at, Type 2, Class 4,(44V to 57V), 0.455A to 0.351A, max.20W	Support 9 ≤ 15V DC, standard 12V/2A	Support 9 ≤ 15V DC, standard 12V/2A	Support 9 ≤ 15V DC, standard 12V/2A
DISPLAY SCREEN					
Type	LED: 2-line dual color English Display		Color LCD Display	LED: 2-line dual color English Display	Color LCD Display
Size	31*15cm, 2,048 dot, Green and Red Color		48*27cm	31*15cm, 8,129 Dot	48*27cm
BODY HOUSING					
Design & Material	Bare Pole, epoxy powder coated			Designed housing, epoxy powder coated	Designed housing, epoxy powder coated
Protection Rate	IP65			IP65	IP65
Fill Light	Option			Standard	Standard
PRICING					
Indication	★	★	★★	★★★	★★★★

*For the L and L2 series, the LPR camera can be mixed and matched with the K, D, or V models. Please consult our sales personnel for detailed information on the differences.

Our SMART PARKING ECOSYSTEM

FRONT END

BACK END

NEXT ACTIVITIES FLOW

(Digital transformation ready)
Malls, Offices buildings, Schools, Government etc

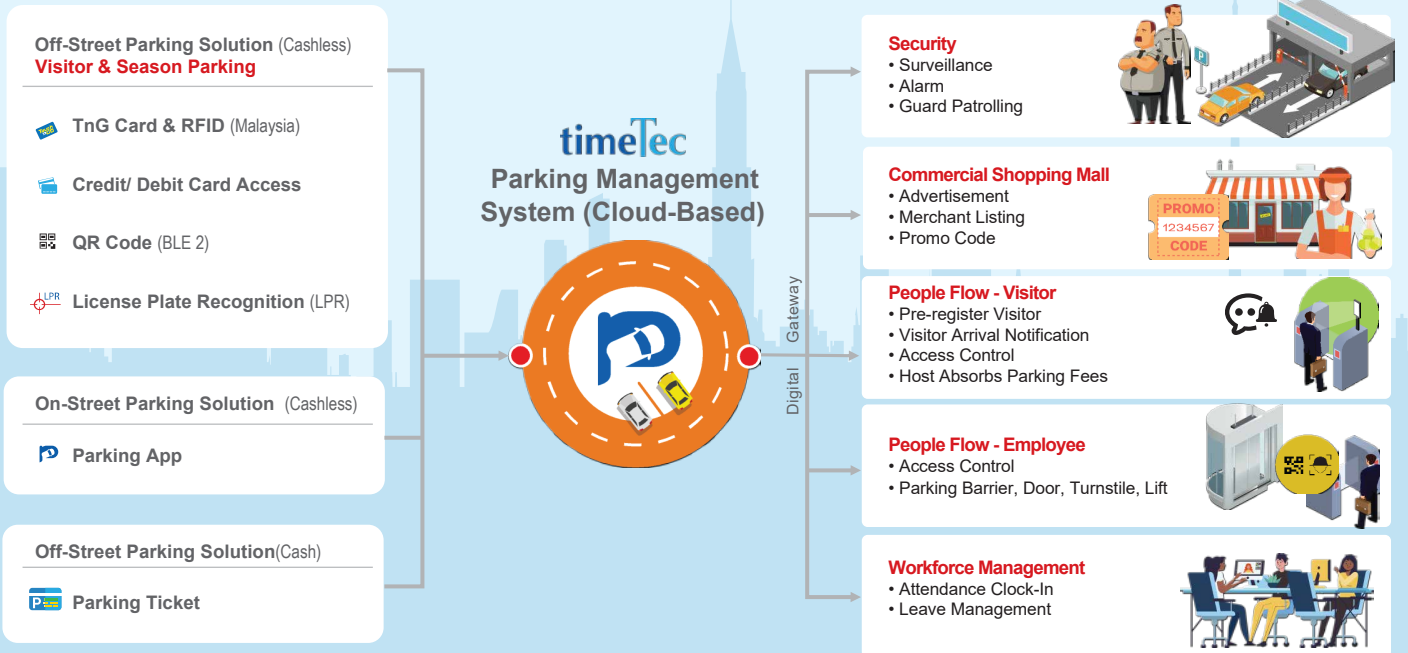

- 20+ Years on the Market
- 28+ Patents
- 400+ Partners Worldwide
- 1M+ FingerTec & IoT Installations
- 1M+ Cloud Solution Users
- ISO 27001
- CMMI Level 3
- PDPA & GDPR Compliance

CLIENTELE



Authorized Reseller